

## LES STUDIOS ENTREPRISE – STUDIO A

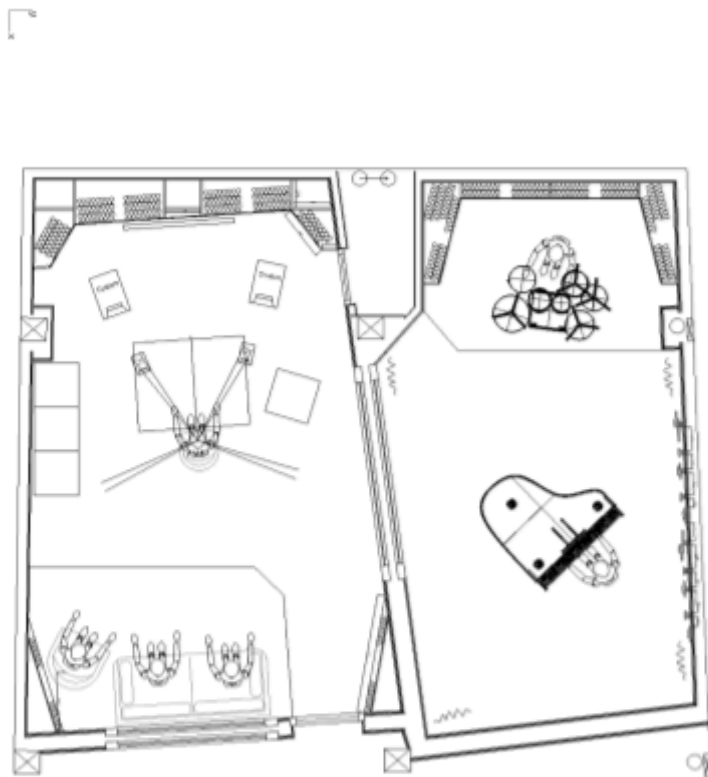

### Dimensions :

**Control Room:** 27m<sup>2</sup> (6m x 4,50m x 3m)

**Live Room:** 28m<sup>2</sup> (7m x 4m x 3m)

## Equipments

### MONITORING

#### **Speakers**

- Genelec 1030-A (x2)
- Barefoot MM27 Gen2 (x2)
- Yamaha NS-10 M Studio (x2)
- Focal TRI06 be (x2) (Studio C)
- Focal Shape 65 (x2)

#### **Amplifiers**

- Bryston 3B

#### **Monitoring system**

- Dangerous Music Monitor ST + Remote

#### **Headphones/Cue System**

- Cue System SM Pro Audio HP6E (class A) (x4)
- Behringer P16-l
- Behringer P16-D
- Behringer P16-M (x7)
- Beyerdynamic DT 770 (x7)
- Sennheiser HD25
- Sony MDR 7506

### MULTITRACK SYSTEM

#### **Pro Tools System**

- Pro Tools Ultimate 2022,10.0 HDX
- Mac Studio 2022
- Universal Audio UAD-2 Octo

#### **LCD Display**

- BenQ 24" monitor
- Philips LCD 42" Full HD
- Blackmagic Design Intensity - Pro Video available in the tracking room

#### **A/D, D/A Converters**

- Avid Pro Tools HD I/O 16x16 (x3)
- Apogee DA-16X (feeds the summing mixer)
- Antelope Pure2

#### **Microphone Cabling**

- Gepco
- Mogami

#### **Audio Interface**

- UAD Apollo Twin x Quad Mk2
- UAD Apollo x8p
- Focusrite Clarett+ 2pre
- Focusrite Scarlett Solo 3rd gen

### SOFTWARE

- FabFilter Bundle
- Waves V15 Bundle
- Antares Autotune Pro
- Plugin Alliance Bundle
- Valhalla Bundle
- UAD
- Izotope RX10
- Soundtoys
- Melodyne
- VocalAlign Ultra

### HARDWARE

#### **Microphone Preamps**

- API 512c (x2)
- Neve 1073 DPA
- Neve 1073 DPX Preamp (Studio C)
- Focusrite Red 1
- DW Fearn VT-2
- Chandler Limited TG2 500 (x2)
- Studer Series 902 (x20)
- Thermionic The Rooster 2

#### **Compressors/Limiters**

- Neve 33609 J
- Retro Instrument Sta-Level
- Tube-Tech CL 1B
- Manley Variable MU (stereo)
- Anthony DeMaria Labs ADL 1500 (stereo)
- Urei 1176 silverface
- Rupert Neve Portico II
- Empirical Labs Distressor (x2)

#### **EQ**

- Neve 1073 DPX EQ (Studio C)
- API 550 (x2)
- APSI 559
- Retro Instrument 2A3
- Chandler TG 12345 Curve Bender
- Siemens W295b (x8)

#### **Effects**

- EMT 140 stereo (tube)
- AKG BX-15
- AKG BX-20E
- Lexicon Model 200
- Lexicon PCM 70
- Roland RE 201 Space
- Eventide H3000-D/SE
- Maestro Echoplex EP-3
- Dbx 120xp Subharmonic Synthesizer
- Roland SBF-325 Flanger
- Boss CE 300 Super Chorus
- Overstayer M-A-S
- Thermionic Culture The Culture Vulture

#### **Pedals**

- Tc Teletronic June-60
- Moog Moogerfooger MF-101
- Boss CE-1 Chorus Ensemble
- Boss TU-2
- Boss BF-1
- Boss RV-6
- JHS Packrat
- Surfycat Metal Reverb 2.1
- Dod Fx12
- Behringer TU-100
- Electro-Hammonix Deluxe Memory Man
- Chase Bliss Generation Loss MKII
- Chase Bliss Mood MKII
- Univox Super-fuzz
- Utility Perkolator
- Korg Pitchback

#### **Direct Boxes**

- Radial JDI (passive) (x2)
- Radial Reamp Pro (passive)
- Radial Pro 48
- Radial Pro D
- Zod Audio ID DI (tube)
- Sescom SM1A passive
- Klark Teknik DN100
- ARD XDI
- Cloudlifter (x2)

#### **Console**

- Studer 902 (20 Channels)

## MICROPHONES

### **Large Diaphragm**

#### **Condensers**

- Neumann U67 vintage
- Neumann U87 vintage
- Neumann U87 Ai (**x2 stereo pair**)
- Neumann U47 FET
- ATM U47
- Sony C-800G
- AKG C414b-ULS (**x2**)
- Beesneez BC12A (**x2 stereo pair**)

### **Small Diaphragm**

#### **Condensers**

- AKG C 451 B
- Josephson e22s (**x2**)
- Schoeps CMC6 + MK4 (**x2 stereo pair**)
- Scopelabs The Periscope

### **Ribbons**

- Coles 4038 (**x2 stereo pair**)
- Royer Labs R-121 MP (**x2 stereo pair**)
- AEA R88
- Oktava ML19, 80s russian RCA BK5B (**x2 stereo pair**)
- Toshiba K-Type, 50s japanese RCA 77D/DX (**x2 stereo pair**)

### **Dynamics**

- AKG D112
- Sennheiser MD-421 (**x2**)
- Shure SM57 (**x3**)
- Shure SM58
- Shure SM7b
- Beyerdynamic M201TG
- Beyerdynamic Soundstar X1N

(**x2**)

- Beyerdynamic M69n
- Electro Voice Re20

## INSTRUMENTS

### **Piano**

- Sauter upright P110

### **Electric Pianos**

- Wurlitzer 200A
- Yamaha CP60M
- Yamaha CP 20

### **Organs**

- Wurlitzer 200A
- Moog Opus 3
- Honner Symphonic 31
- Vox Continental 2

### **Keyboards/Synthesizer**

- ARP Omni 2
- ARP Odyssey
- Elex Strings
- Moog Minimoog
- Emerald
- Sequential Prophet V
- Roland Super JV
- Roland Juno 60
- Rally Autoharpe
- Korg M500
- Korg MS20

### **Midi Keyboards**

- M-Audio KeystationMK3 (88 touches)
- Arturia Essential Keylab (61 keys) (**x2**)
- Komplete (32 keys)

### **Acoustic Guitars**

- Cort AJ860
- Martin GPC-11E
- Takamine E30

## **Electric Guitars**

- Fender Bass Precision
- Fender Stratocaster 62, Reissue 2010
- Ibanez 2380 Les Paul Recording 1970's

## **Amplifiers**

- Fender Hot Rod Deluxe
- Fender Pro Amp (1961)
- Vox AC30 (1968)
- Roland Cube-60
- Ampeg B18N(1964)

## **Drum Kits**

- Camco kit 1969 (24"/13"/16")
- Rogers kit 1968-1969 (22" x 13"x16")
- Snares (*Camco, Rogers, Gretsch Steel*)
- Zildjian cymbal KR18C Kerope Ride (18")
- Zildjian cymbal 1K-Custom Dark Hi-Hat (14")

## **Drum Machines/Samplers**

- Roland SBX 10
- Diktat Elektron