

LES STUDIOS ENTREPRISE – STUDIO A

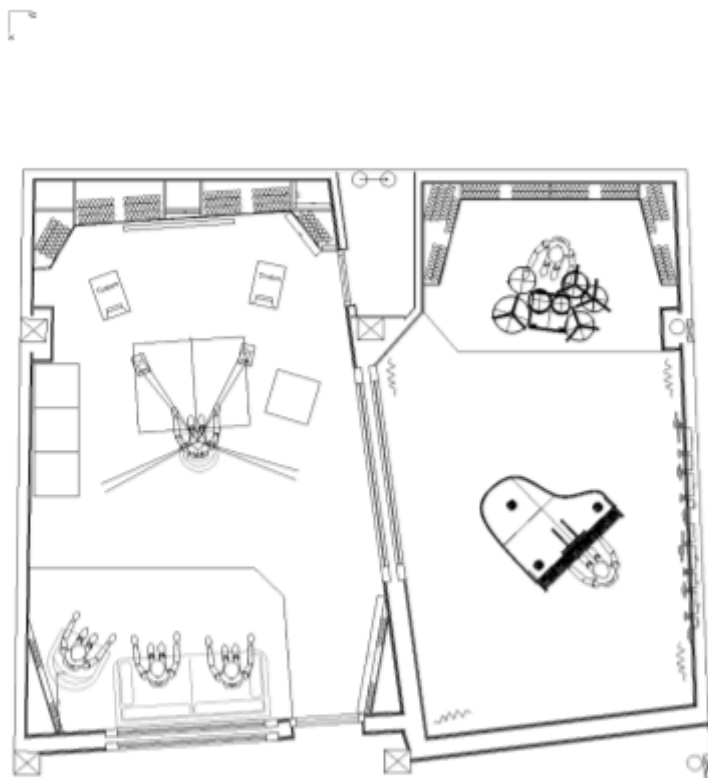

Dimensions :

Control Room: 27m² (6m x 4,50m x 3m)

Live Room: 28m² (7m x 4m x 3m)

Equipments

MONITORING

Speakers

- Genelec 1030-A **(x2)**
- Barefoot MM27 Gen2 **(x2)**
- Yamaha NS-10 M Studio **(x2)**
- Focal TRI06 be **(x2)** (*Studio C*)
- Focal Shape 65 **(x2)**

Amplifiers

- Bryston 3B

Monitoring system

- Dangerous Music Monitor ST
+ Remote

Headphones/Cue System

- Cue System SM Pro Audio
HP6E (class A) **(x4)**
- Behringer P16-l
- Behringer P16-D
- Behringer P16-M **(x7)**
- Beyerdynamic DT 770 **(x7)**
- Sennheiser HD25
- Sony MDR 7506

MULTITRACK SYSTEM

Pro Tools System

- Pro Tools Ultimate
2022,10.0 HDX
- Mac Studio 2022
- Universal Audio UAD-2 Octo

LCD Display

- BenQ 24" monitor
- Philips LCD 42" Full HD
- Blackmagic Design Intensity -
Pro Video available in the
tracking room

A/D, D/A Converters

- Avid Pro Tools HD I/O 16x16
(x3)
- Apogee DA-16X (feeds the
summing mixer)
- Antelope Pure2

Microphone Cabling

- Gepco
- Mogami

Audio Interface

- UAD Apollo Twin x Quad Mk2
- UAD Apollo x8p
- Focusrite Clarett+ 2pre
- Focusrite Scarlett Solo 3rd
gen

SOFTWARE

- FabFilter Bundle
- Waves V15 Bundle
- Antares Autotune Pro
- Plugin Alliance Bundle
- Valhalla Bundle
- UAD
- Izotope RX10
- Soundtoys
- Melodyne
- VocalAlign Ultra

HARDWARE

Microphone Preamps

- API 512c **(x2)**
- Neve 1073 DPA
- Neve 1073 DPX Preamp
(*Studio C*)
- Focusrite Red 1
- DW Fearn VT-2
- Chandler Limited TG2 500
(x2)
- Studer Series 902 **(x20)**
- Thermionic The Rooster 2

Compressors/Limiters

- Neve 33609 J
- Retro Instrument Sta-Level
- Tube-Tech CL 1B
- Manley Variable MU (stereo)
- Anthony DeMaria Labs ADL
1500 (stereo)
- Urei 1176 silverface
- Rupert Neve Portico II
- Empirical Labs Distressor **(x2)**

EQ

- Neve 1073 DPX EQ
(*Studio C*)
- API 550 **(x2)**
- APSI 559
- Retro Instrument 2A3
- Chandler TG 12345 Curve
Bender
- Siemens W295b
(x8)

Effects

- EMT 140 stereo (tube)
- AKG BX-15
- AKG BX-20E
- Lexicon Model 200
- Lexicon PCM 70
- Roland RE 201 Space
- Eventide H3000-D/SE
- Maestro Echoplex EP-3
- Dbx 120xp Subharmonic
Synthesizer
- Roland SBF-325 Flanger
- Boss CE 300 Super Chorus
- Overstayer M-A-S
- Thermionic Culture The
Culture Culture

Pedals

- Tc Teletronic June-60
- Moog Moogerfooger MF-101
- Boss CE-1 Chorus Ensemble
- Boss TU-2
- Boss BF-1
- Boss RV-6
- JHS Packrat
- SurfycbearMetal Reverb 2.1
- Dod Fx12
- Behringer TU-100
- Electro-HamoniX Deluxe
Memory Man
- Chase Bliss Generation Loss
MKII
- Chase Bliss Mood MKII
- Univox Super-fuzz
- Utility Perkolator
- Korg Pitchback

Direct Boxes

- Radial JDI (passive) **(x2)**
- Radial Reamp Pro (passive)
- Radial Pro 48
- Radial Pro D
- Zod Audio ID DI (tube)
- Sescom SM1A passive
- Klark Teknik DN100
- ARD XDI
- Cloudlifter **(x2)**

Console

- Studer 902 (20 Channels)

MICROPHONES

Large Diaphragm Condensers

- Neumann U67 vintage
- Neumann U87 vintage
- Neumann U87 AI (**x2 stereo pair**)
- Neumann U47 FET
- ATM U47
- Sony C-800G
- AKG C414b-ULS (**x2**)
- Beesneez BC12A (**x2 stereo pair**)

Small Diaphragm Condensers

- AKG C 451 B
- Josephson e22s (**x2**)
- Schoeps CMC6 + MK4 (**x2 stereo pair**)
- Soyuz 013 Tube-M (**x2**)
- Scopelabs The Periscope

Ribbons

- Coles 4038 (**x2 stereo pair**)
- Royer Labs R-121 MP (**x2 stereo pair**)
- AEA R88
- Oktava ML19, 80s russian RCA BK5B (**x2 stereo pair**)
- Toshiba K-Type, 50s japanese RCA 77D/DX (**x2 stereo pair**)

Dynamics

- AKG D112
- Sennheiser MD-421 (**x2**)
- Shure SM57 (**x3**)
- Shure SM58
- Shure SM7b

- Beyerdynamic M201TG
- Beyerdynamic Soundstar X1N (**x2**)
- Beyerdynamic M69n
- Electro Voice Re20

INSTRUMENTS

Piano

- Sauter upright P110

Electric Pianos

- Wurlitzer 200A
- Yamaha CP60M
- Yamaha CP 20

Organs

- Wurlitzer 200A
- Moog Opus 3
- Honner Symphonic 31
- Vox Continental 2

Keyboards/Synthesizer

- ARP Omni 2
- ARP Odyssey
- Elex Strings
- Moog Minimoog
- Emerald
- Sequential Prophet V
- Roland Super JV
- Roland Juno 60
- Rally Autoharpe
- Korg M500
- Korg MS20

Midi Keyboards

- M-Audio KeystationMK3 (88 touches)
- Arturia Essential Keylab (61 keys) (**x2**)
- Komplete (32 keys)

Acoustic Guitars

- Cort AJ860
- Martin GPC-11E
- Takamine E30

Electric Guitars

- Fender Bass Precision
- Fender Stratocaster 62, Reissue 2010
- Ibanez 2380 Les Paul Recording 1970's

Amplifiers

- Fender Hot Rod Deluxe
- Fender Pro Amp (1961)
- Vox AC30 (1968)
- Roland Cube-60
- Ampeg B18N(1964)

Drum Kits

- Camco kit 1969 (24"/13"/16")
- Rogers kit 1968-1969 (22" x 13"x16")
- Snares (*Camco, Rogers, Gretsch Steel*)
- Zildjian cymbal KR18C Kerope Ride (18")
- Zildjian cymbal 1K-Custom Dark Hi-Hat (14")

Drum Machines/ Samplers

- Roland SBX 10
- Diktat Elektron